

Triga Go Towers 20"x20", 3'x20", 3'x3'

Product Parts

- 1.Top Pole (x4)
- 2.Bottom Pole (x4)
- 3.Top Crossbar (x4)
- 4.Bottom Crossbar (x4)
- 5.Stabilizer Bar (x4)
- 6.Foot (x4)
- 7.Graphic

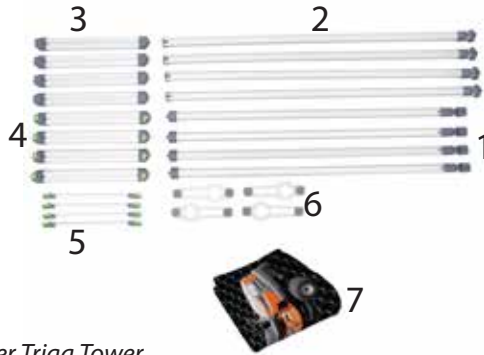

Length of Crossbars will vary per Triga Tower



Display Set-up

Step 1

Attach the Top Pole (1) to the Bottom Pole (2) by turning connector locks.

Place Feet (5) on the floor, place the bottom pole in the slots in the foot, twisting until locked in place.

Repeat until all Top and Bottom Poles are assembled

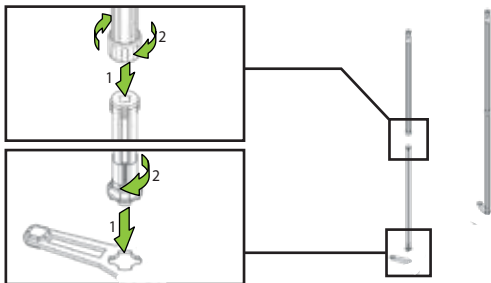

Step 2

Connect the Bottom Crossbars (4) to the Poles by sliding the Bottom Crossbar into the groove on the Bottom Pole (2).

Lock Bottom Crossbar by turning green knobs to locked position

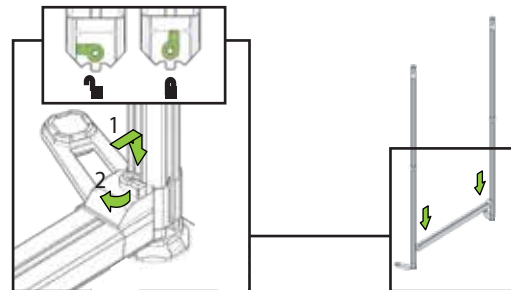

Step 3

Slide the Top Crossbar (2) into the slots on the Top Poles (1).

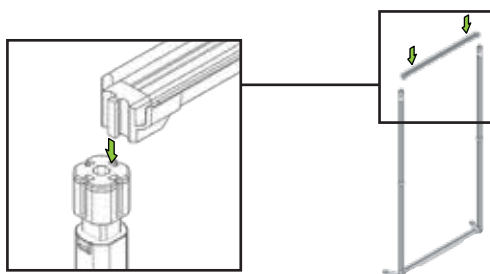

Step 5

Attach the Stabilizer Bar (5) to the Bottom Crossbar (4) and Bottom Pole (2).

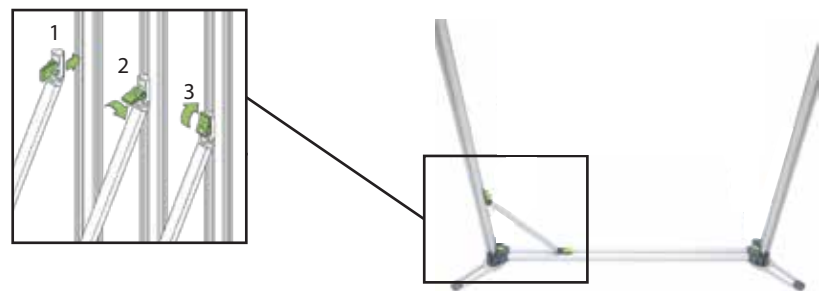

Step 4

Repeat until all Poles and Bottom Crossbars are connected, and tower frame is complete.



Graphic Installation

Step 1

Press down on the tension compressor at the top of each Top Pole (1) until it is in the lower position.

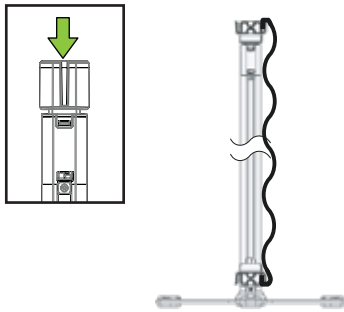

Step 2

Start by inserting the silicone edge into the channel. Continue along the Top and Bottom Crossbars wrapping the graphic around the front and around from left to right, to the other side. Wrap all the way back to the starting point. There will be approximately 9" of graphic overlap.

Step 3

Press down once more on the tension compressor to pop it back up and graphic becomes taut.

Green switch will lock Compressor in its current position.

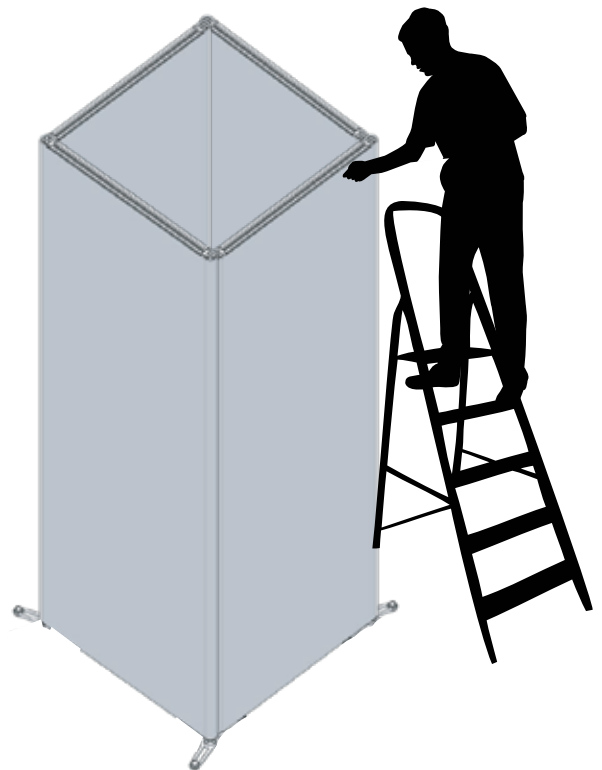
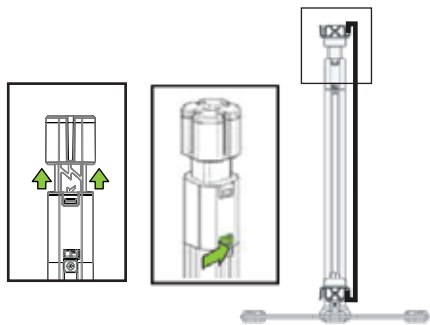

Storage & Care

Place all product parts into Carry Case and store in a cool dry location. To clean non-graphic hardware, wipe with a damp cloth.